

INSTALLATION MANUAL

SPEED classic Wing
engineered for BMW F22, F87 and F87 Competition

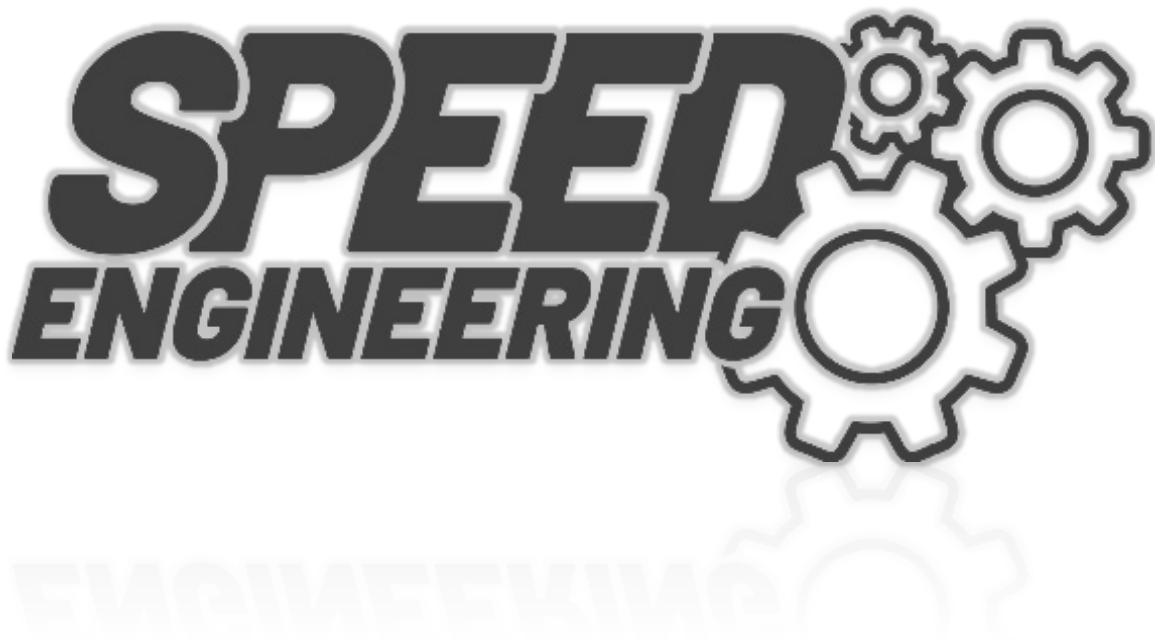

This manual is written with the utmost care. However, should there be any errors, we are not liable for incorrect and unsafe installation or the resulting damage!

Before you start, please check the completeness of your kit and make sure you have the right tools!

Scope of delivery:

(wing related parts):

1x carbon fibre wing

2x cutting templates

2x milled aluminum stands for the wing

x milled aluminum adapter for the wing

2x carbon fibre reinforcement plates

(fastening materials):

12x M6x10 lens head screw

12x M6 threaded sleeve



Step 1



Fix the cutting template at the position shown in the picture above.

Step 2



Mark the inside outline of the cutting template on to your trunk lid.

Step 3



Cut along the lines. A rectangle is formed.

STEP 4

Place the Counterplate inside the cutted rectangle and mark the hole to drill through.



Step 5



Drill the mounting holes: Both 6mm!



Step 6



**Apply adhesive for automotive parts all around the cutting edge. Please note:
Apply to the cutting edges aswell, to protect the trunk link against corrosion!**

Step 7



Fix the supplied reinforcement plates into the cutted holes.

Step 8



**Press the reinforcement plate firmly against the trunk lid.
It's good if the glue oozes out on the sides.**

Step 9

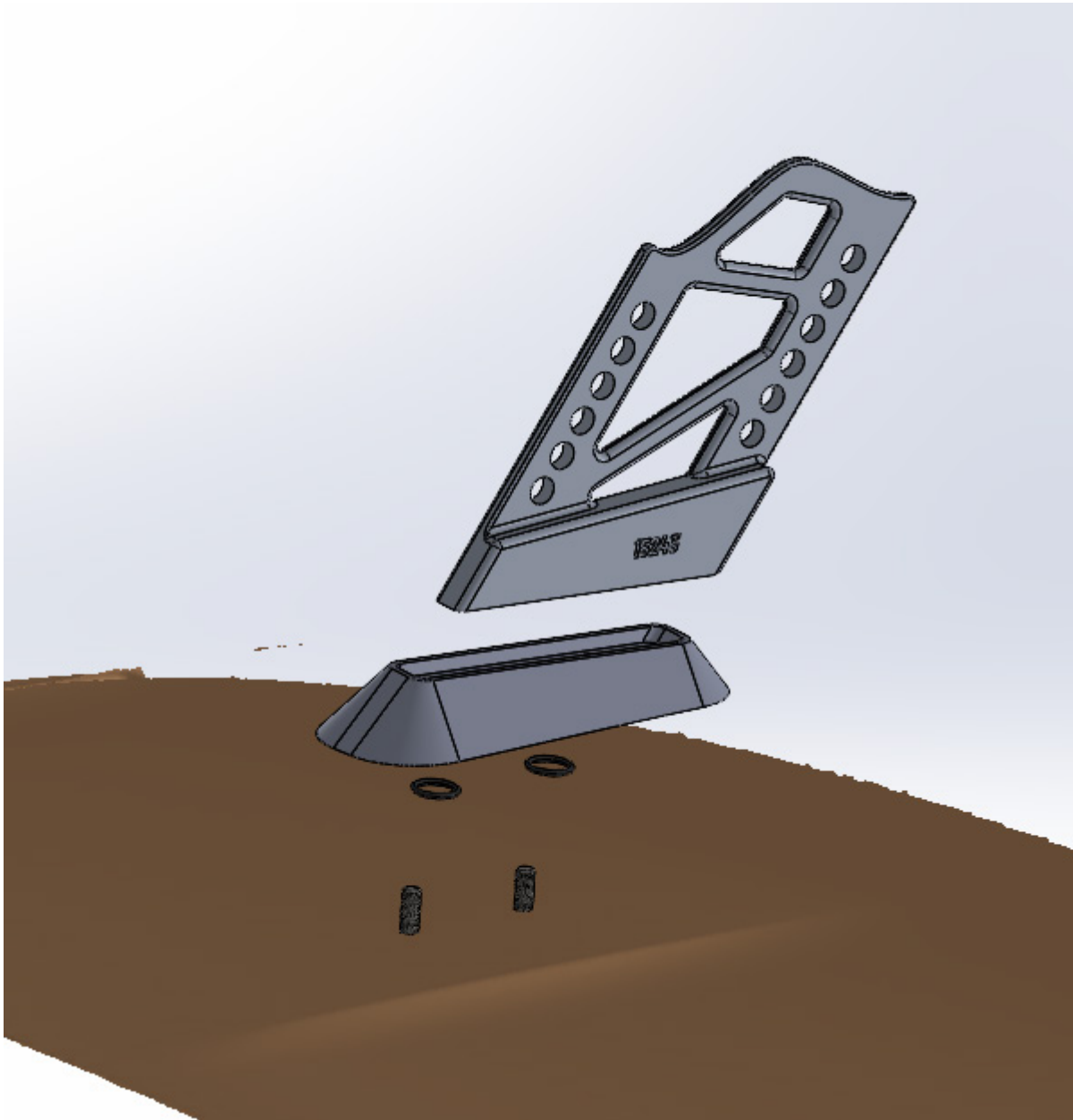

Mount the aluminum stands, the wing adapters and the o-rings with the M6x25 screws onto your trunk lid. The thread is already inside the aluminum parts.



Step 10

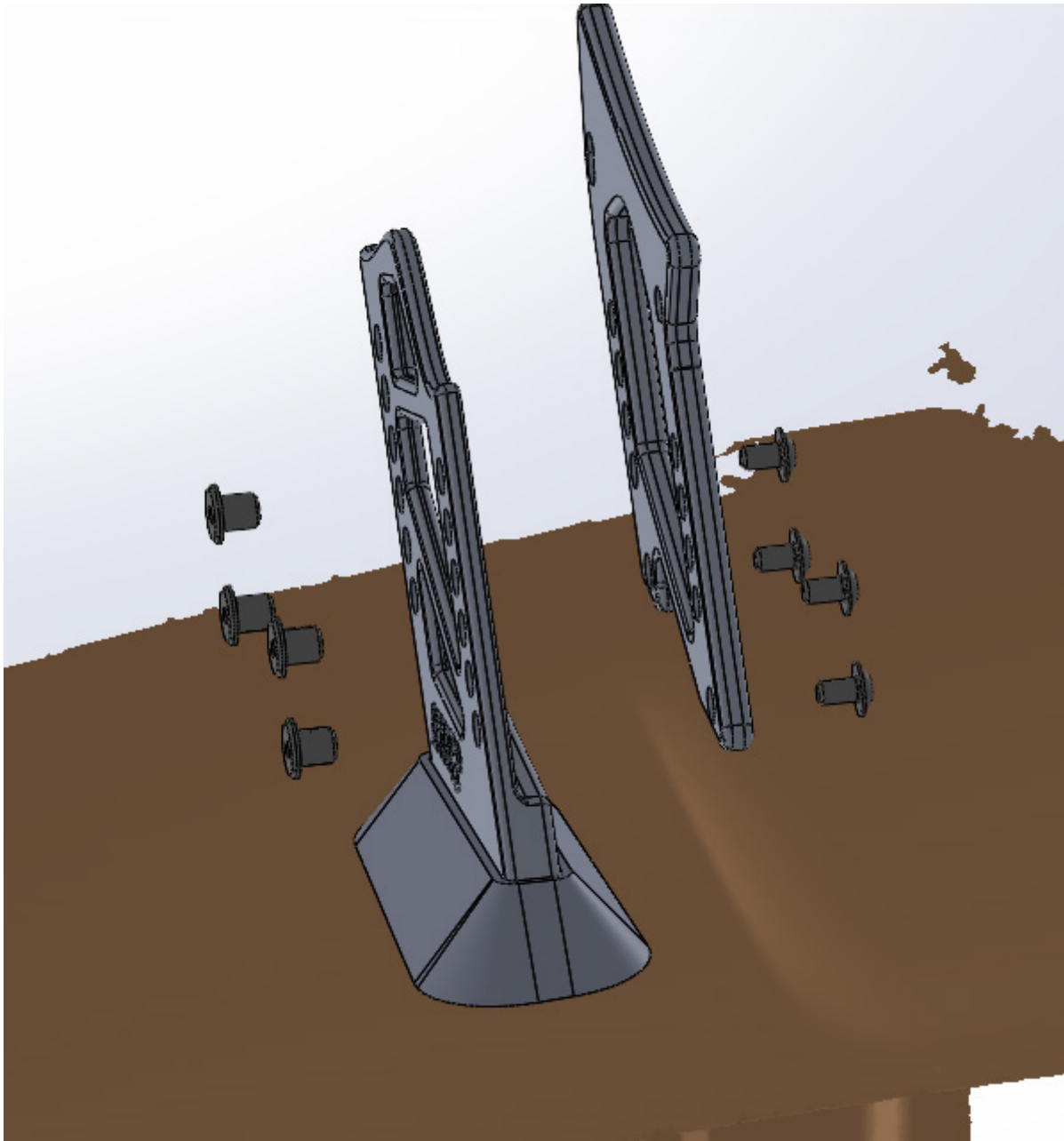

***Mount the Wing adapter to the wing holder
with 8x M6 sleeve nuts and 8x M6x10
lenshead screws***

Step 11

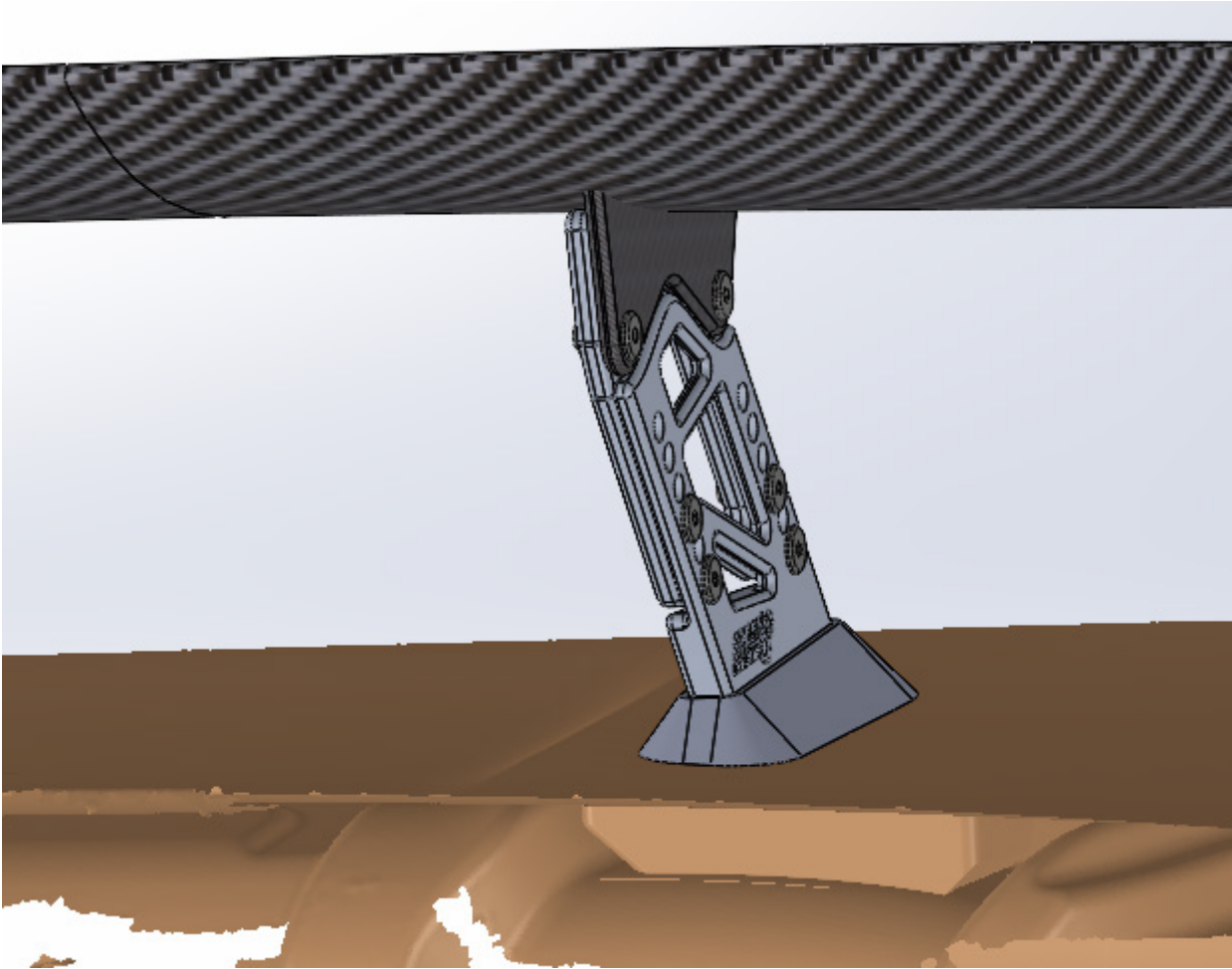

Fix the wing with the supplied M6x10 lens head screws and the threaded sleeves.

Step 11

Please let the glue harden for at least 24 hours to ensure maximum rigidity and a firm connection to your trunk lid.

Done!

We hope you enjoy your SPEED Engineering product.

